

DP-500^{Q&As}

Designing and Implementing Enterprise-Scale Analytics Solutions Using
Microsoft Azure and Microsoft Power BI

Pass Microsoft DP-500 Exam with 100% Guarantee

Free Download Real Questions & Answers **PDF** and **VCE** file from:

<https://www.leads4pass.com/dp-500.html>

100% Passing Guarantee
100% Money Back Assurance

Following Questions and Answers are all new published by Microsoft
Official Exam Center

- ⚙️ **Instant Download** After Purchase
- ⚙️ **100% Money Back** Guarantee
- ⚙️ **365 Days** Free Update
- ⚙️ **800,000+** Satisfied Customers



QUESTION 1

You have an Azure Synapse Analytics dedicated SQL pool.

You need to ensure that the SQL pool is scanned by Azure Purview.

What should you do first?

- A. Register a data source.
- B. Search the data catalog.
- C. Create a data share connection.
- D. Create a data policy.

Correct Answer: A

QUESTION 2

You plan to generate a line chart to visualize and compare the last six months of sales data for two departments. You need to increase the accessibility of the visual. What should you do?

- A. Replace long text with abbreviations and acronyms.
- B. Configure a unique marker for each series.
- C. Configure a distinct color for each series.
- D. Move important information to a tooltip.

Correct Answer: B

QUESTION 3**HOTSPOT**

You manage a dataset that contains the two data sources as shown in the following table.

Data source	Type of data	Privacy level
Azure SQL database	Sensitive company data	Private
Microsoft SharePoint folder	Non-sensitive company data	Private

When you attempt to refresh the dataset in powerbi.com, you receive the following error message: "[Unable to combine data] Add Columns is accessing data sources that have privacy levels which cannot be used together. Please rebuild

this

data combination."

You discover that the dataset contains queries that fold data from the SharePoint folder to the Azure SQL database.

You need to resolve the error. The solution must provide the highest privacy possible.

Which privacy level should you select for each data source? To answer, select the appropriate options in the answer area.

NOTE: Each correct selection is worth one point.

Hot Area:

Azure SQL database:

	▼
Organizational	
Private	
Public	

SharePoint folder:

	▼
Organizational	
Private	
Public	

Correct Answer:

Azure SQL database:



SharePoint folder:



Box 1: Private

This Formula.Firewall error is the result of Power Query's Data Privacy Firewall (aka the Firewall)

Note: Folding is a term that refers to converting expressions in M (such as filters, renames, joins, and so on) into operations against a raw data source (such as SQL, OData, and so on).

Box 2: Organizational

Organizational Limits the visibility of a data source to a trusted group of people. It is isolated from all Public data sources, but is visible to other Organizational data sources. A common example is a Microsoft Word document on an intranet SharePoint site with permissions enabled for a trusted group.

QUESTION 4

DRAG DROP

You have a shared dataset in Power BI named Dataset1.

You have an on-premises Microsoft SQL Server database named DB1.

You need to ensure that Dataset1 refreshes data from DB1.

Which three actions should you perform in sequence? To answer, move the appropriate actions from the list of actions to the answer area and arrange them in the correct order.

Select and Place:

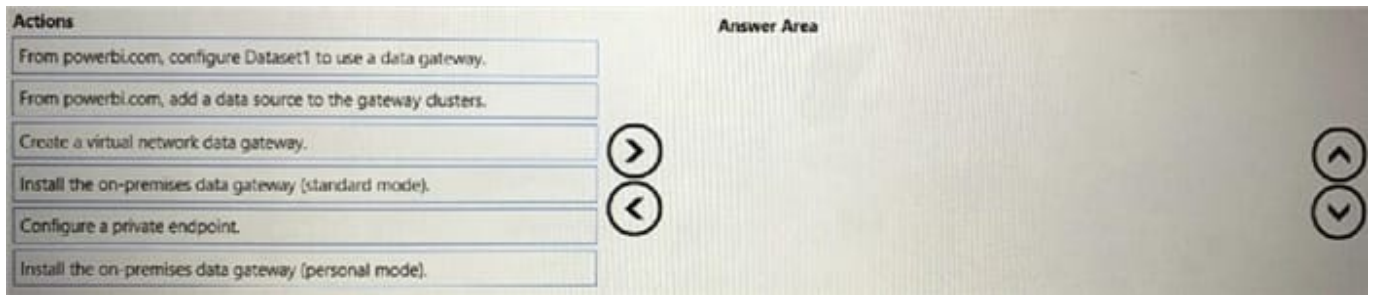

Correct Answer:

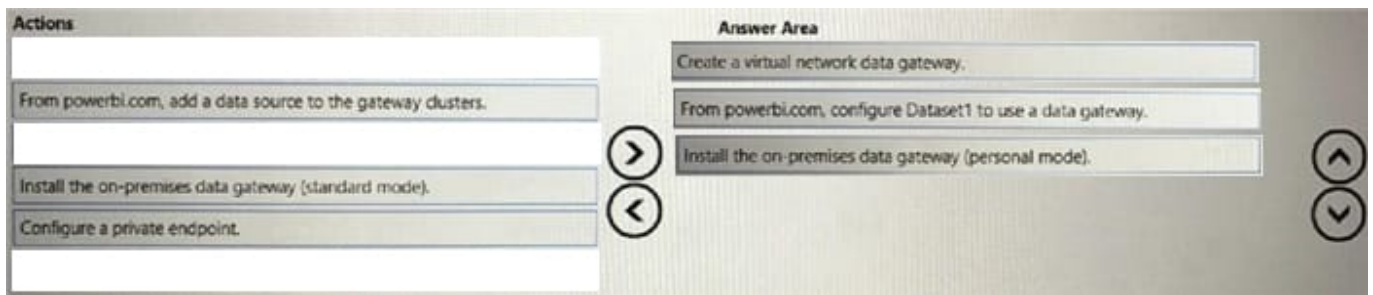

QUESTION 5

You need to provide users with a reproducible method to connect to a data source and transform the data by using an AI function. The solution must meet the following requirement

Minimize development effort.

Avoid including data in the file.

Which type of file should you create?

- A. PBIDS
- B. PBIX
- C. PBIT

Correct Answer: C

[DP-500 VCE Dumps](#)

[DP-500 Study Guide](#)

[DP-500 Braindumps](#)